

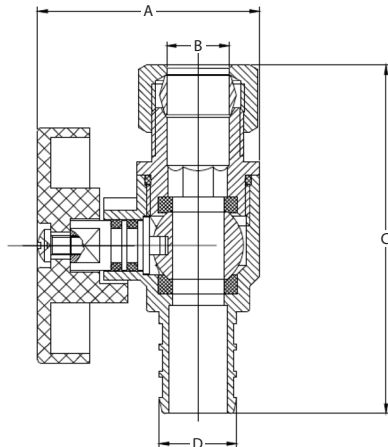

S33-EFQTST-1238WPE .3399070

INLET x OUTLET	DIMENSIONS (in)			
	A	B	C	D
1/2" PEX-B x 3/8" OD Comp	1.35	0.38	2.17	0.47



SUBMITTAL SHEET

PROJECT INFORMATION

Job Name:

Location:

Engineer:

Contractor:

P.O. Number:

Representative:

MODELS

☐ S33-EFQTST-1238WPE

DESCRIPTION

Stream33® Straight Stop Quarter-Turn Valve connects to a supply line and allows the control of water flow to a plumbing fixture. The quarter-turn handle easily and quickly turns water flow to the end fixture on and off, making it simple to perform repairs or maintenance without needing to turn the water off in the household.

FEATURES

- Lead-free chrome-plated brass body
- Quarter-turn handle
- Straight stop valve

OPERATING SPECIFICATIONS

- Temperature rating: 32° - 185° F
- Pressure rating: 200 PSI maximum

APPROVALS

- cUPC
- NSF/ANSI 61
- AB1953

MATERIAL SPECIFICATIONS

Body	C46500 Brass
Stem	C89500 Brass
O-Ring	NBR
Handle	ABS
Screw	Stainless Steel 667
Slip Joint Washer	H62 Brass
Slip Joint Nut	HPB57-3 Brass
PEX Insert Material	C46500 Brass