

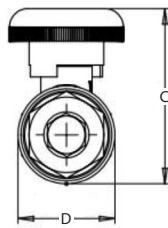

S33-EFQTSWT-7012 .3389298

INLET x OUTLET	DIMENSIONS (in)			
	A	B	C	D
1/2" SWT x 3/8" OD Comp	1.46	1.97	1.46	0.81

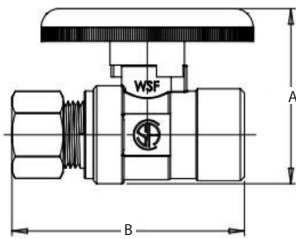

## SUBMITTAL SHEET

### PROJECT INFORMATION

Job Name:

Location:

Engineer:

Contractor:

P.O. Number:

Representative:

### MODELS

□ S33-EFQTSWT-7012

### DESCRIPTION

Stream33® Straight Stop Quarter-Turn Valve connects to a supply line and allows the control of water flow to a plumbing fixture. The quarter-turn handle easily and quickly turns water flow to the end fixture on and off, making it simple to perform repairs or maintenance without needing to turn the water off in the household.

### FEATURES

- Lead-free chrome-plated brass body
- Quarter-turn handle
- Straight stop valve

### OPERATING SPECIFICATIONS

- Temperature rating: 41° - 160° F
- Pressure rating: 125 PSI maximum

### APPROVALS

- cUPC
- NSF/ANSI 61
- AB1953

#### MATERIAL SPECIFICATIONS

<b>Body</b>	Brass
<b>Stem</b>	Brass
<b>O-Ring</b>	Rubber
<b>Handle</b>	Zinc
<b>Screw</b>	Stainless Steel
<b>Slip Joint Washer</b>	Brass
<b>Slip Joint Nut</b>	Brass
<b>PEX Insert Material</b>	N/A