

SUBMITTAL SHEET

PROJECT INFORMATION

Job Name:

Location:

Engineer:

Contractor:

P.O. Number:

Representative:



S33-EFBRPT-1714C .3403152

DESCRIPTION	DIMENSIONS (in)							
	A	B	C	D	E	F	G	H
1-1/4" x 1-1/4"	10.15	3.15	7	2.16	R40	0.47	2.4	2.67

S33-EFBRPT-1412C .3403153

DESCRIPTION	DIMENSIONS (in)							
	A	B	C	D	E	F	G	H
1-1/2" x 1-1/4"	10.85	3.35	7.5	2.36	R42	0.47	2.3	2.67

S33-EFBRPT-1712C .3403154

DESCRIPTION	DIMENSIONS (in)							
	A	B	C	D	E	F	G	H
1-1/2" x 1-1/2"	10.85	3.35	7.5	2.36	R42	0.47	2.3	2.67

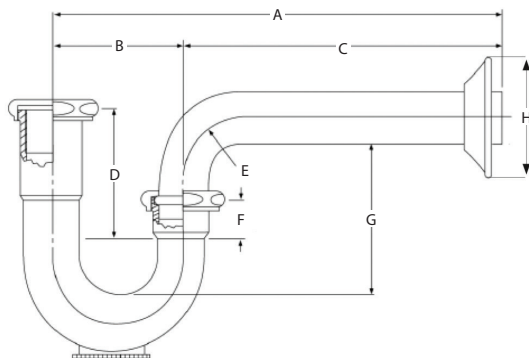

MODELS

☐ S33-EFBRPT-1714C

☐ S33-EFBRPT-1712C

☐ S33-EFBRPT-1412C

DESCRIPTION

Stream33® Brass Tubular P-Trap with Cleanout is used to connect into a wall-connected sink drain system in tubular applications. The solid brass construction ensures durability and reliability.

FEATURES

- Durable 17-gauge brass construction
- With cleanout
- Chrome-plated
- Escutcheon included

APPROVALS

- cUPC