



## FEATURES

- 1.28 GPF high efficiency toilet
- 3" Flush valve
- Left and right hand trip levers available
- Fully glazed trap way
- Meets or exceeds the following:
  - UPC listed
  - EPA WaterSense HET Listed



## AVAILABLE FINISHES

 WHITE

Model	Trip Lever	ID
S33TBE12-ADA/S33TANK-L	Left	.3503016
S33TBE12-ADA/S33TANK-R	Right	.3503015

## WARRANTY

5-Year warranty. Visit [stream33.com](http://stream33.com) for details.

## RECOMMENDED ACCESSORIES

Visit [stream33.com](http://stream33.com) for a complete list:

- Closet bolts
- Stop valves
- Supply lines
- Toilet seats
- Wax rings

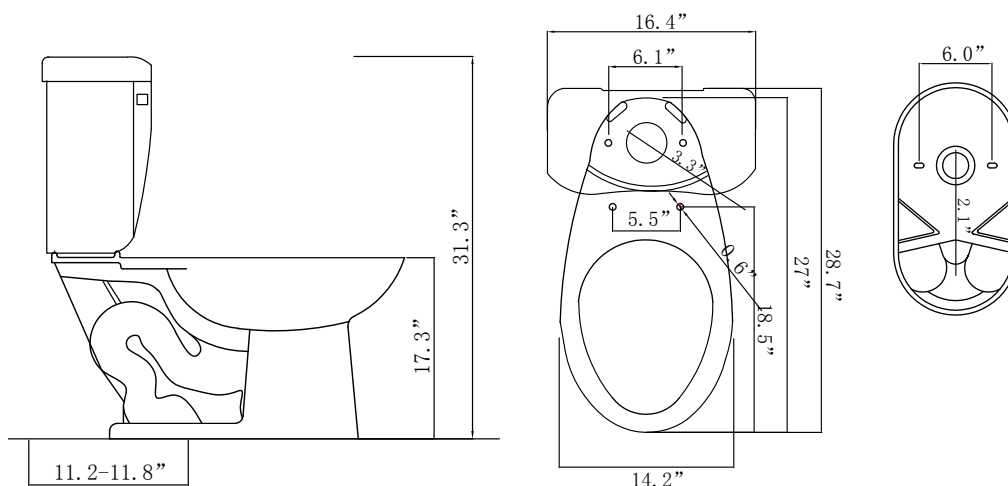

NOTE: Above are the rough-in measurements. They may vary 1/4" (±).