

## SUBMITTAL SHEET

### PROJECT INFORMATION

Job Name:

Location:

Engineer:

Contractor:

P.O. Number:

Representative:



S33-PSDSS2 .3477329

DESCRIPTION	DIMENSIONS (in)		
	A	B	C
2" PVC SHOWER DRAIN	4.29	2.37	2.39

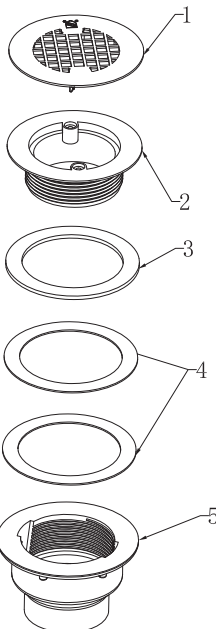
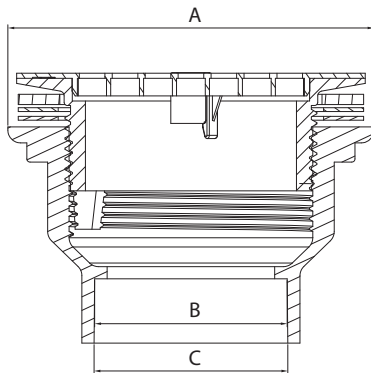

### MODELS

□ S33-PSDSS2

### DESCRIPTION

Stream33® PVC Solvent Weld Shower Drains are designed for use with shower stall bases. The drain body is sealed to the shower base with a fiber and rubber washer.

### FEATURES

- 2" Solvent Weld Connection
- Stainless Steel Strainer
- Screws on to 2-5/8" Centers

### APPROVALS

- cUPC

### MATERIAL SPECIFICATIONS

1	Strainer	SS430
2	Floor Drain in Body	PVC
3	Washer	NBR
4	Paper Washer	Kraft Paper
5	Floor Drain	PVC