

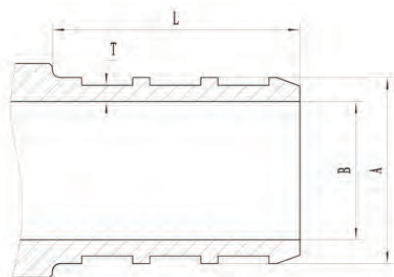

Model	ID	Size	Color
S331238BPCOU-PEXB	.3487381	1/2" x 3/8"	Brass
S3312BPCOU-PEXB	.3484229	1/2" x 1/2"	Brass
S3334BPCOU-PEXB	.3484230	3/4" x 3/4"	Brass
S333412BPCOU-PEXB	.3484231	3/4" x 1/2"	Brass
S331BPCOU-PEXB	.3484232	1" x 1"	Brass
SS134BPCOU-PEXB	.3484233	1" x 3/4"	Brass



Size	Outside Dia. (A)	Min. ID (B)	Min. Insert Length (L)	Min. Wall (T)
3/8"	0.345"	0.23"	0.625"	0.025"
1/2"	0.471"	0.35"	0.625"	0.028"
5/8"	0.57"	0.451"	0.625"	0.032"
3/4"	0.667"	0.53"	0.625"	0.037"
1"	0.856"	0.71"	0.795"	0.041"
1-1/4"	1.045"	0.87"	0.94"	0.045"

Outside diameter within variance of 0.004".

### SUBMITTAL SHEET

#### PROJECT INFORMATION

Job Name:

Location:

Engineer:

Contractor:

P.O. Number:

Representative:

#### MODELS

- ☐ S331238BPCOU-PEXB
- ☐ S3312BPCOU-PEXB
- ☐ S3334BPCOU-PEXB
- ☐ S333412BPCOU-PEXB
- ☐ S331BPCOU-PEXB
- ☐ S3314BPCOU-PEXB

#### FEATURES

- C46500 (lead free) brass

#### OPERATING SPECIFICATIONS

- Can be used with PEX tubing manufactured to ASTM Standard F876-877
- Manufactured to ASTM Standard F1807
- Max pressure/temperature: 150 PSI at 210°F

#### APPROVALS

- NSF/ANSI Standard 14
- NSF/ANSI Standard 61
- NSF/ANSI Standard 372
- SE, CSA B137.5

#### RECOMMENDED ACCESSORIES

Model	ID	Description
S3312CCR	.3484321	1/2" Copper Crimp Ring
S3334CCR	.3484322	3/4" Copper Crimp Ring
S331CCR	.3484323	1" Copper Crimp Ring
S3312SSCC	.3492324	1/2" Stainless Steel Cinch Clamp
S3334SSCC	.3492323	3/4" Stainless Steel Cinch Clamp
S331SSCC	.3492326	1" Stainless Steel Cinch Clamp