

## SUBMITTAL SHEET

### PROJECT INFORMATION

Job Name:

Location:

Engineer:

Contractor:

P.O. Number:

Representative:

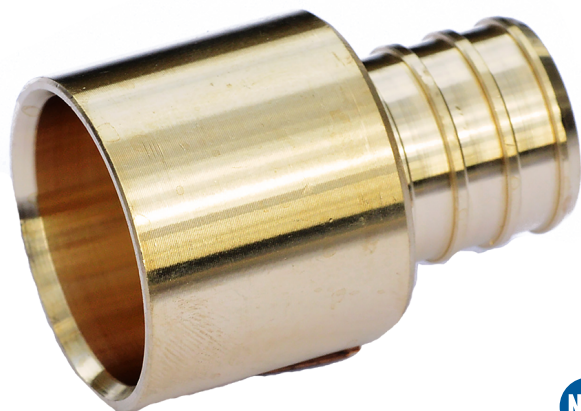

Model	ID	Size	Color
S3312BPFSW-PEXB	.3484236	1/2" x 1/2"	Brass
S3334BPFSW-PEXB	.3484238	3/4" x 3/4"	Brass
S331BPFSW-PEXB	.3484239	1" x 1"	Brass

### MODELS

- ☐ S3312BPFSW-PEXB
 ☐ S331BPFSW-PEXB
 ☐ S3334BPFSW-PEXB

### FEATURES

- C46500 (lead free) brass

### OPERATING SPECIFICATIONS

- Can be used with PEX tubing manufactured to ASTM Standard F876-877
- Manufactured to ASTM Standard F1807
- Max pressure/temperature: 150 PSI at 210°F

### APPROVALS

- NSF/ANSI Standard 14
- NSF/ANSI Standard 61
- NSF/ANSI Standard 372
- SE, CSA B137.5

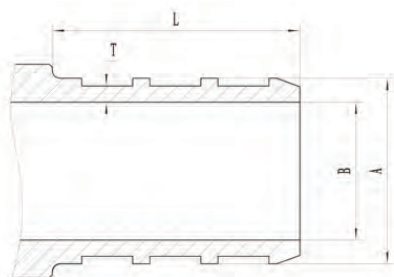

Size	Outside Dia. (A)	Min. ID (B)	Min. Insert Length (L)	Min. Wall (T)
3/8"	0.345"	0.23"	0.625"	0.025"
1/2"	0.471"	0.35"	0.625"	0.028"
5/8"	0.57"	0.451"	0.625"	0.032"
3/4"	0.667"	0.53"	0.625"	0.037"
1"	0.856"	0.71"	0.795"	0.041"
1-1/4"	1.045"	0.87"	0.94"	0.045"

Outside diameter within variance of 0.004".

### RECOMMENDED ACCESSORIES

Model	ID	Description
S3312CCR	.3484321	1/2" Copper Crimp Ring
S3334CCR	.3484322	3/4" Copper Crimp Ring
S331CCR	.3484323	1" Copper Crimp Ring
S3312SSCC	.3492324	1/2" Stainless Steel Cinch Clamp
S3334SSCC	.3492323	3/4" Stainless Steel Cinch Clamp
S331SSCC	.3492326	1" Stainless Steel Cinch Clamp