



S3312PEXABV .3470542

SIZE (A)	DIMENSIONS		
	B	C	D
1/2"	2.72"	1.57"	3.62"

S3334PEXABV .3470544

SIZE (A)	DIMENSIONS		
	B	C	D
3/4"	3.41"	1.77"	4.13"

S331PEXABV .3470546

SIZE (A)	DIMENSIONS		
	B	C	D
1"	4.18"	1.91"	4.13"

SUBMITTAL SHEET

PROJECT INFORMATION

Job Name:

Location:

Engineer:

Contractor:

P.O. Number:

Representative:

MODELS

☐ S3312PEXABV

☐ S331PEXABV

☐ S3334PEXABV

DESCRIPTION

Stream33® PEX A Full Port Ball Valve quarter-turn handle easily and quickly turns flow to the supply on and off, making it simple to perform repairs or maintenance.

FEATURES

- PEX A
- Brass-Copper Alloy Body
- Lead Free

OPERATING SPECIFICATIONS

- Temperature rating: -20° - 250° F
- Pressure rating: 200 PSI maximum

APPROVALS

- cUPC
- NSF 61/372
- CSA
- UL
- FM

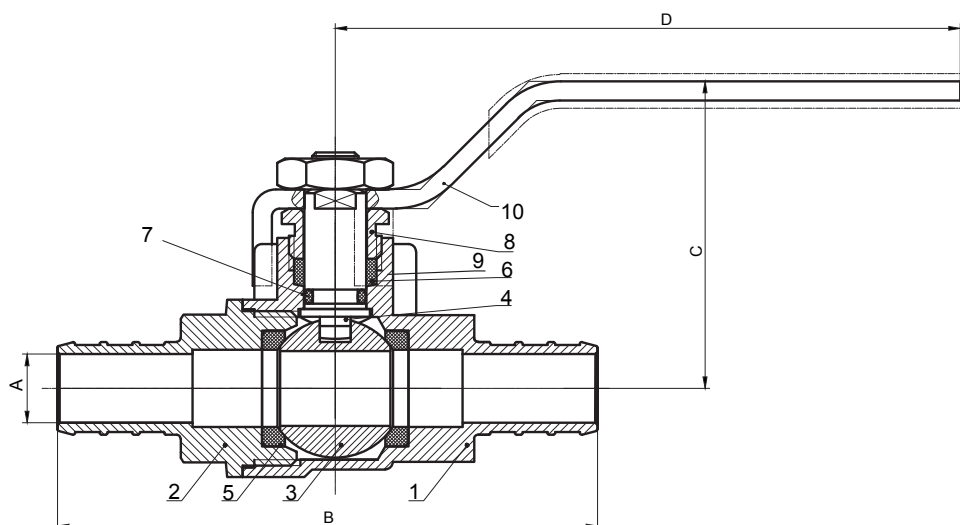

	MATERIAL SPECIFICATIONS	
1	Body	C46500
2	Caps	C46500
3	Ball	C46500
4	Stem	C48600
5	Ball Seat	PTFE
6	Gasket	HH040P
7	Thrust Washer	EPDM
8	Gland	C3770-T
9	Gland Gasket	PTFE
10	Handle	Q235+PVC